



PLUMPJACK

SQUAW VALLEY INN

RESIDENCES

3B1

Ground Floor

APPROX. 2,444 SQ FT

3 Bed + Den
4 Baths

E101, W101

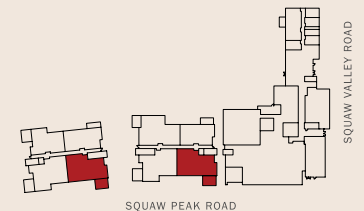

This is not an offer to sell but is intended for information only. The developer reserves the right to make modifications in materials, specifications, finishes, floor plans, pricing, scheduling and delivery of homes without prior notice. Plans are not to scale. All dimensions are approximate and subject to normal construction variances and tolerances. All square footages are approximate, are for informational purposes only and subject to change at any time. They are not intended as, nor can they be relied upon, as an exact representation, express or implied. Differing methods of measuring square footage are used for different purposes and will therefore provide different results. Exclusively represented by SagePoint, DRE 01987029. 🏠

LivePlumpJackSquaw.com